



PRODUCTION INFORMATION



San Diego
Civic Theatre

This information is provided to assist you in planning an event in the San Diego Civic Theatre. Should additional information be required, please feel free to contact us for prompt attention. Larger scale versions of the drawings included here are also available.

San Diego Theatres welcomes the opportunity to work with you and to make your event a success.

GENERAL ACCESS

Administration & Booking(619) 615-4000
 Event & Patron Services(619) 615-4003
 Primary FAX(619) 615-4001
 Civic Theatre Websitewww.sdcivic.org

Ticket Sales & Information(619) 570-1100

Ticketing Services

Management(619) 615-4170
 Ticketing Services FAX(619) 615-4175

Production & Facility Services

Management(619) 615-4150
 Production FAX(619) 615-4155

Theatre LocationThird Avenue and “B” Street
 San Diego, CA 92101
 Theatre Ticket OfficeSecond Avenue and “B” Street
 Civic Theatre Ticketing
 1100 Third Avenue
 San Diego, CA 92101
 Administration andSan Diego Theatres
 Mailing Address1100 Third Avenue
 San Diego, CA 92101
 Stage Door andThird Avenue and “C” Street
 Loading Dock

GENERAL INFORMATION

The Civic Theatre is a 2,967 capacity performing arts venue located in downtown San Diego. It is the performing home of the San Diego Opera, Broadway/San Diego and regularly hosts performances of the California Ballet, touring orchestras and dance companies, Broadway musicals and plays, concerts, film presentations, lectures, etc. The Theatre is owned by the City of San Diego and operated by San Diego Theatres for the benefit of the community.

An 1,150 car parking garage is located across the plaza adjacent to the Civic Theatre.

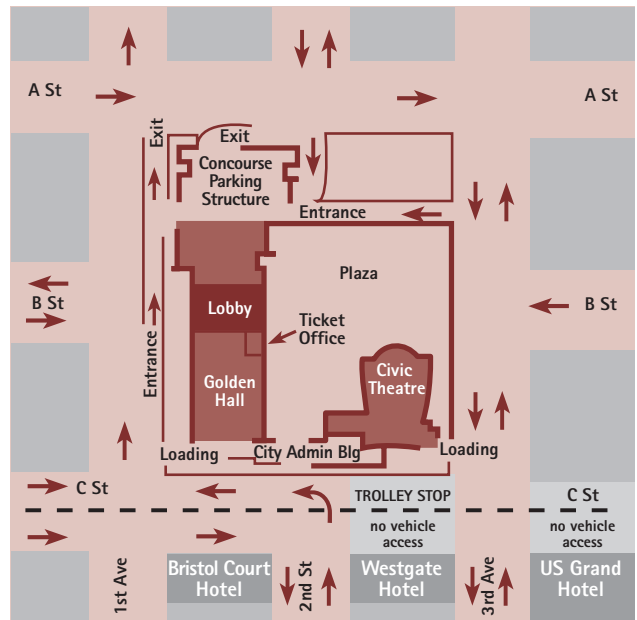
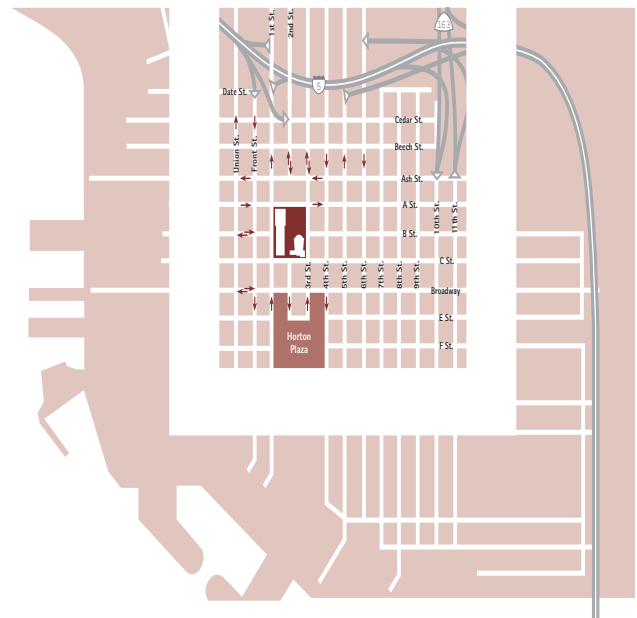

PRODUCTION INFORMATION

Production crews are members of IATSE, Local #122

Proscenium Opening

Height 29'-6"
 Width..... 56'-0"

Selected Measurements

Proscenium to Up-Stage Wall (up/down stage) . . . 55'-3"
 Curtain Line to Apron Edge..... 6'-0"
 Last set of lines to Back Wall 9'-0"
 Floor to Grid 81'-0"
 Stage at Curtain Line to Balcony Rail..... 93'-7"
 Stage at Curtain Line to Follow Spot Booth 151'-0"

The Stage is constructed of soft wood covered with 1/4" masonite. The performance area is painted black. The standard Orchestra Pit accommodates approximately 45 musicians and the Extended Pit accommodates about 60 musicians. Exact capacity will vary depending on the quantity and types of instrumentation utilized. Use of the Standard Pit will reduce audience seating capacity by 55, the Extended Pit reduces capacity by 90 seats.

The loading dock is at street level and will hold two (2) semis. Because the vehicle area slopes down to the dock, trailers over 13'-6 high will have difficulty clearing the outer door, especially when empty.

Empty trailers are to be removed from the dock. Please contact the Production Office if holding/staging areas are needed.

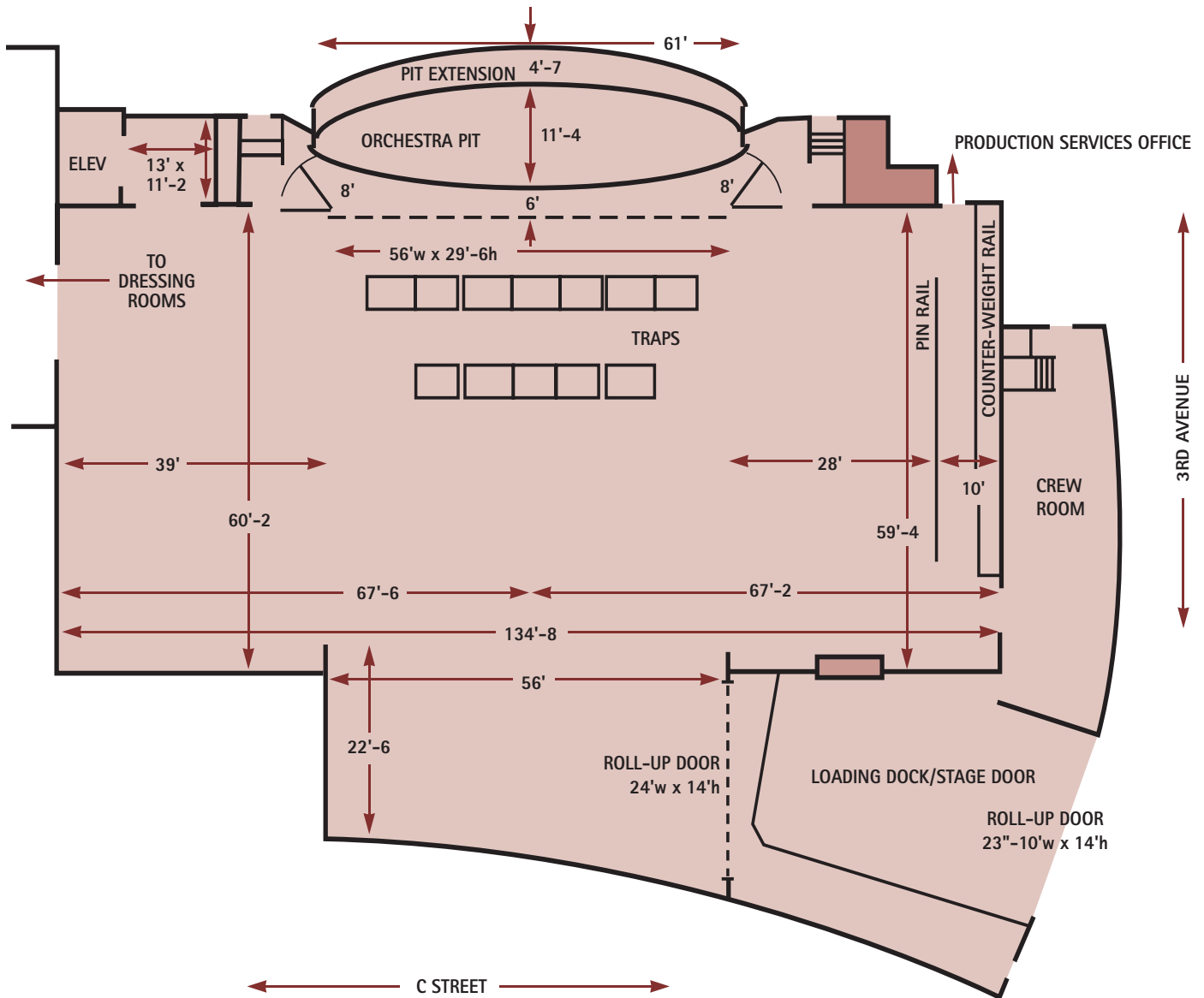

COUNTER-WEIGHT PLOT

SET		ITEM		LOCATION	
Fire Curtain/Proscenium	0' 3"	24	16' 8"	47	32' 2"
1 Teaser	0' 9"	25	17' 5"	48 #4 Black Border	32' 7"
2 Tormentor	1' 6"	26 Full Stage Black	18' 0"	49 #4 Black Leg	33' 2"
3 House Curtain	2' 2"	26a	19' 5"	50 #4 Electric	33' 8"
4 Black Border	2' 9"	27 NO SET WIRE GUIDE		51	34' 9"
5	3' 8"	28 NO SET WIRE GUIDE		52	35' 5"
6 #1 Electric	4' 3"	29	20' 2"	53 Stage-Right Ladders	Muled
7	4' 11"	30	20' 8"	54	36' 8"
8	5' 6"	31	21' 6"	55 Stage-Left Ladders	Muled
9 #1 Black Border	6' 5"	32	22' 2"	56	38' 1"
10 #1 Black Leg	7' 1"	33 #3 Black Border	23' 0"	57 NO SET	
11	7' 6"	34 #3 Black Leg	23' 6"	58 NO SET	
12	8' 9"	35 #3 Electric	24' 2"	59 #5 Black Border	39' 4"
13	9' 8"	36	24' 9"	60	40' 0"
14	10' 3"	37	25' 5"	61 #5 Black Leg	40' 6"
15	11' 0"	38	26' 2"	62 #5 Electric	41' 2"
16	11' 6"	39	26' 9"	63	43' 2"
17	12' 2"	40 Full Stage Black	27' 05"	64 Full Stage Black	43' 9"
18	13' 0"	41	28' 2"	65	44' 6"
19 #2 Black Border	13' 6"	42	28' 9"	66	45' 6"
20 #2 Black Leg	14' 2"	43	29' 6"	67	46' 2"
21 #2 Electric	14' 8"	44	30' 2"	67a Wire Arbor Guide	47' 11"
22	15' 5"	45	30' 9"	68	49' 5"
23	16' 2"	46	31' 5"	68a Wire Guide	50' 5"

*200 lb. limit

There are 64 sets of counter-weighted lines on steel guides, and four sets on wire rope guides. All sets are on 8" centers where possible. All sets can be cleared and flown to the grid to a minimum of 65'.

The battens are 70' long and are of pipe truss construction, except for Set #69 which is single pipe.

The Front Curtain is manually operated and can be either flown or drawn. Front Curtain and associated tormentors and

teaser are red in color. Other house goods are black. Standard House Opening is 52' for the Torms, 44' for all Black goods.

Fly Floor is Stage-Right on Deck. #1 Loading Bridge is 45' above stage and #2 is 70'. Grid Height is 81'. Pin Rail is Stage-Right on Deck.

Proscenium is 56' w x 29' 6" h.

CIVIC THEATRE CROSS SECTION

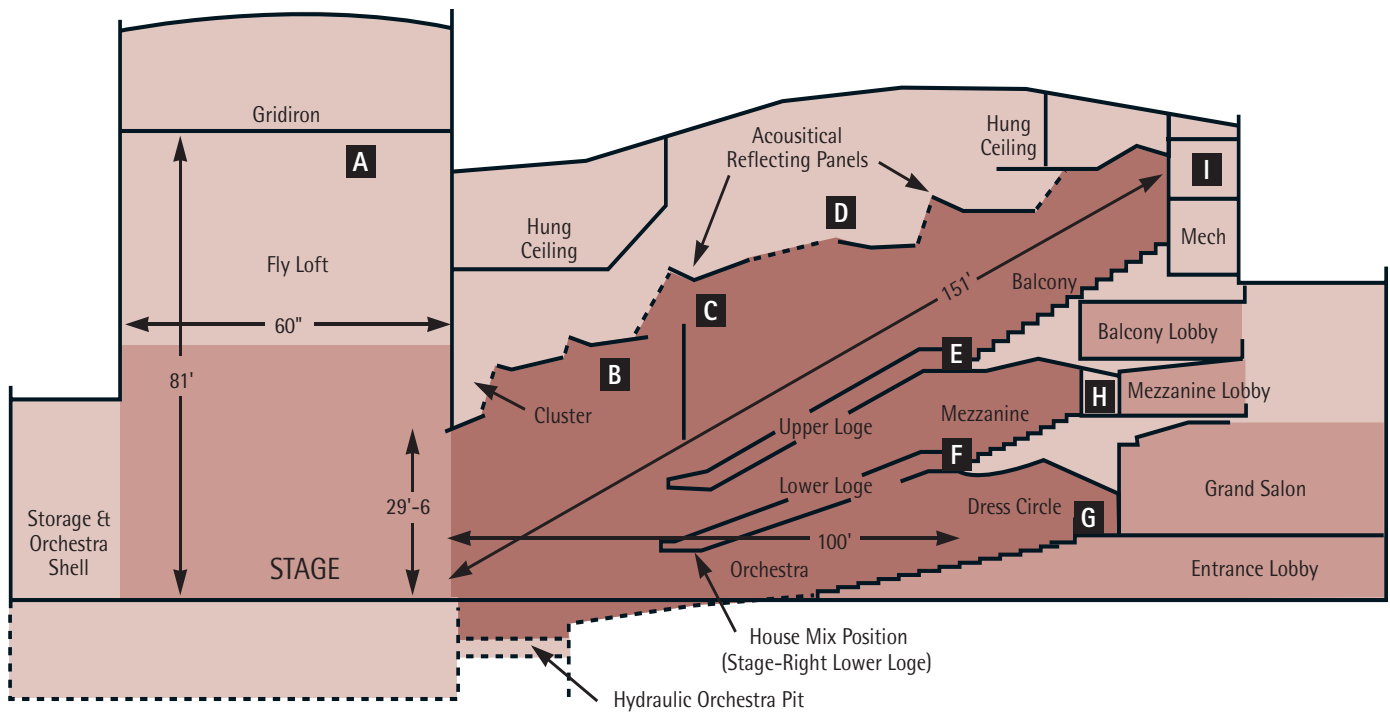

CROSS SECTION	
A	Over stage grid
B	Near Box Boom - 28' to curtain line
C	Far Box Boom - 48' to curtain line
D	High Bay - 96' from curtain line
E	Balcony Rail - 94' from curtain line
F	Mezzanine Rail - 86' to curtain line
G	Road mix position
H	House Lighting Control Booth
I	Follow Spot Booth - 151' to curtain line

SOUND SYSTEM

The house speaker system is a 4-way JBL cluster centered overhead of the proscenium with an added delay system for loge and balcony coverage. Touring productions are urged to use the system to provide general house fill as it has been balanced for the hall. Stage mounted systems will generally not provide adequate coverage for the balcony areas. The house sound console is a Midas Heritage 1000, 32-channel mixer located at the front of the stage-right lower loge.

For road systems, a mix position is available for use at the rear of the Dress Circle, just off-center to stage right, so a minimum of 250' of cable must be provided by the sound company. Use of this location typically results in a loss of 27 seats. The number of seats lost also depends on the equipment and working requirements of the operator(s)–

seat “kills” may range from 27 to 41 or more seats. The labor costs associated with the removal and re-installation of mixer seats or any other seats are assessed to the user/licensee.

Stage Manager’s position is traditionally Stage-Right with communications available to all positions in the Theatre.

Program material and backstage paging are available in the dressing rooms and backstage area.

This Theatre is equipped with a Sound Associates infra-red listening system to assist the hearing impaired. An audio feed from the touring console is requested for the operation of this system. The theatre is also equipped with audio description listening devices.

ELECTRICAL INFORMATION

Two ETC Eos Lighting Control Boards with Network ETC Net 2 is located in the lighting control booth at the rear of the Mezzanine.

The system incorporates DMX 512 protocol nodes located throughout the Theatre which are connected via an Ethernet-based data distribution system. The system connects to five hard-wired Sensor Plus dimmer racks in the under-stage basement and an additional 96 dimmer portable rack located on the stage-right patch bay shelf.

Intercom and program material are wired to the booth.

DMX locations include:

- Mid-house designer’s location with a network tap allowing connection to a portable network node.
- Six remote locations - Box Booms (R & L), Mezzanine rail, Eyebrow, Down-stage left, and High-Bay.

Power consists of:

- Two road switches, rated at 400 amps, 3 phase 110/220 (1,200 total amps per switch) are located stage-right, cam lock tie in.
- One road switch, rated at 100 amps, 3 phase 110/220 (300 total amps) located on the down-stage left basement, dedicated for sound.
- Two 100 amp, 3 phase 110/220 (300 amps) are located up stage-right on the loading dock.
- One additional road switch, rated at 400 amps, 3 phase (1,200 total amps), located stage-right can be made available—rental fee applies.

The follow-spot booth is at the rear of the Balcony, 151’ from stage. The booth has three (3) Lycian 3,000 watt Xenon Followspots and provisions for additional spots or projection. Intercom and program material are wired to the booth.

A total of 558 circuits are available on stage and in the house. All circuits are 20 amp. All circuits are equipped with the appropriate 3-pin stage connector. The principal lighting positions available in front of the proscenium include:

- High Bay (cove) 28 circuits—In the ceiling above the orchestra section are 24 lekos (575 Source 4).
- Proscenium Wells 8 circuits per side - Located Stage-Right and Left, just off the apron, these alcoves have adjustable lighting positions from stage level to 30’ above the stage floor.
- Balcony Rail 36 circuits
- Mezzanine Rail 20 circuits
- Box Booms 14 circuits per side—Directly above the front of the Upper Loges Stage-Right and Left the booms are unmasked 20’ vertical pipes for mounting instruments on sidearms.

STAGE CIRCUIT DETAIL			
CIRCUIT QUANTITY	RECEPTACLE LOCATION	AMPACITY	NOTES
36	Balcony Front	20	
28	House High Bay		4
28	Mezzanine Rail		
16	Box Boom, Stage-Right		
16	Box Boom, Stage-Left		
8	Proscenium, Down Stage-Right Wells		
8	Proscenium, Down Stage-Left Wells		
4	Proscenium, Stage-Left		
4	Proscenium, Stage-Right		
36	Anti Proscenium	20	1,5
36	1st Electric	20	
32	2nd Electric	20	
30	3rd Electric		
30	4th Electric		
24	5th Electric	20	
4	5th Electric	50	1,5
48	Floor Pockets	20	
18	Stage-Right Electrics Ladder	20	1
18	Stage-Left Electrics Ladder	20	1
96	Portable Dimmer Rack Patch Panel	20	6
8	Houselight Control	50	

554 - 20 Amp Dimmer Cubicles with connected Load Receptacles
 4 - 50 Amp Dimmer Cubicles with connected Load Receptacles

- Note
- 1) Load Circuit(s) parallel with other(s)
 - 2) Wire Dimmer Cubicle Output to “TC-1” and Dead End Connectors in “TC-1”
 - 3) Wire Dimmer Cubicle Output to “TC-1” and Dead End Connectors in “TC-BC”
 - 4) 20 Amp Dimmer rating, Cabling and Connectors for 30 amp
 - 5) Road Patch panel located Down Stage-Right
 - 6) Portable Dimmer Rack is located on the Patch Bay shelf stage-right.

EQUIPMENT INFORMATION

Equipment Provided at No Charge—Subject to Availability

Curtains	Black legs and Borders Black Back Drop White Scrim
Microphones (first 3 no charge)	AKG 451 EB, Shure SM 81 PZM Sennheiser 421 Shure SM 57, SM 58, SM 99 Sony ECM 50 Lavalier Countryman Isomax 4 Direct boxes
Lecterns	Free-Standing
Music Equipment	Conductor's podium Music Stands with and without lights

INSTRUMENT TYPE*	INVENTORY
Source 4s-5 degree (add'l lens tube)	35
Source 4s-10 degree (add'l lens tube)	24
Source 4s-19 degree	55
Source 4s-26 degree	69
Source 4s-36 degree	28
Miscellaneous	
360 Q	
6x9, 6x12, 6x16	
6x22	
S-4 Par 750w	30
8" Fresnels	55
PAR 64s	45
Cyclorama pans	
STRAND	6
BERKEY	6
MR 16S-Mini Strip	8
Par 56 Striplights - 300w	12

*House hang available upon request
Inventory subject to current availability

Equipment Available on Rental Basis—Rates Upon Request

Pianos	
Concert Grand	9' Baldwin 1 available
Baby Grand	5'7" Steinway 1 available
Upright	Yamaha concert 1 available
Orchestra Shell	walls and ceilings
Additional PA	Full range cabinets with JBL subs
Monitor System	Yamaha wedges and JBL SR cabinets
Intercom System	Clear Com
Follow Spots	Lycian 3,000 watt Xenon
Wireless Microphone	Shure ULX (hand held and lavalier)
Risers	
Ballet Dance Floor	d'Ansur modular sprung flooring, to 64' wide x 48' deep and Harlequin surface
Tape Machines	
CD Player	Tascam
Cassette	Tascam
Telephones	6 telephone lines have been permanently installed in the backstage area for production use (a usage fee will apply). Please contact the Production staff for available locations or to arrange special or additional installations.
Courtesy Phone	Dressing Room area Stage Left No charge for local calls
Genie 36' AWP	2 available—first one at no charge
Internet Broadband	A hard-wired connection is available in the Green Room and wireless service is available throughout the Dressing Room area and Backstage. (an access fee will apply.)
Washer & Dryer	3 sets located in the understage area

CIVIC THEATRE BACKSTAGE MAP

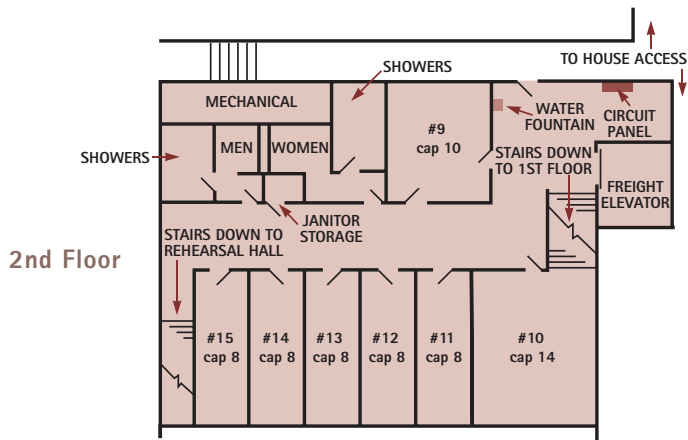

DRESSING ROOMS

There are 15 dressing rooms available on two floors stage-left. At full capacity, these facilities will accommodate 92 people. All dressing rooms are equipped with mirrors, lights, wash basins, clothes racks, convenience outlets, etc. Toilet facilities and showers are nearby (Dressing Rooms #1 and #2 have private restrooms and showers). Drinking water is available throughout the facility. Three sets of washer and dryer are available for use (rental fee applies) and are located in the storage area below stage, stage-right. A small Company/Show Office space is available in the dressing room area. Four telephone lines are available (rental charges apply).

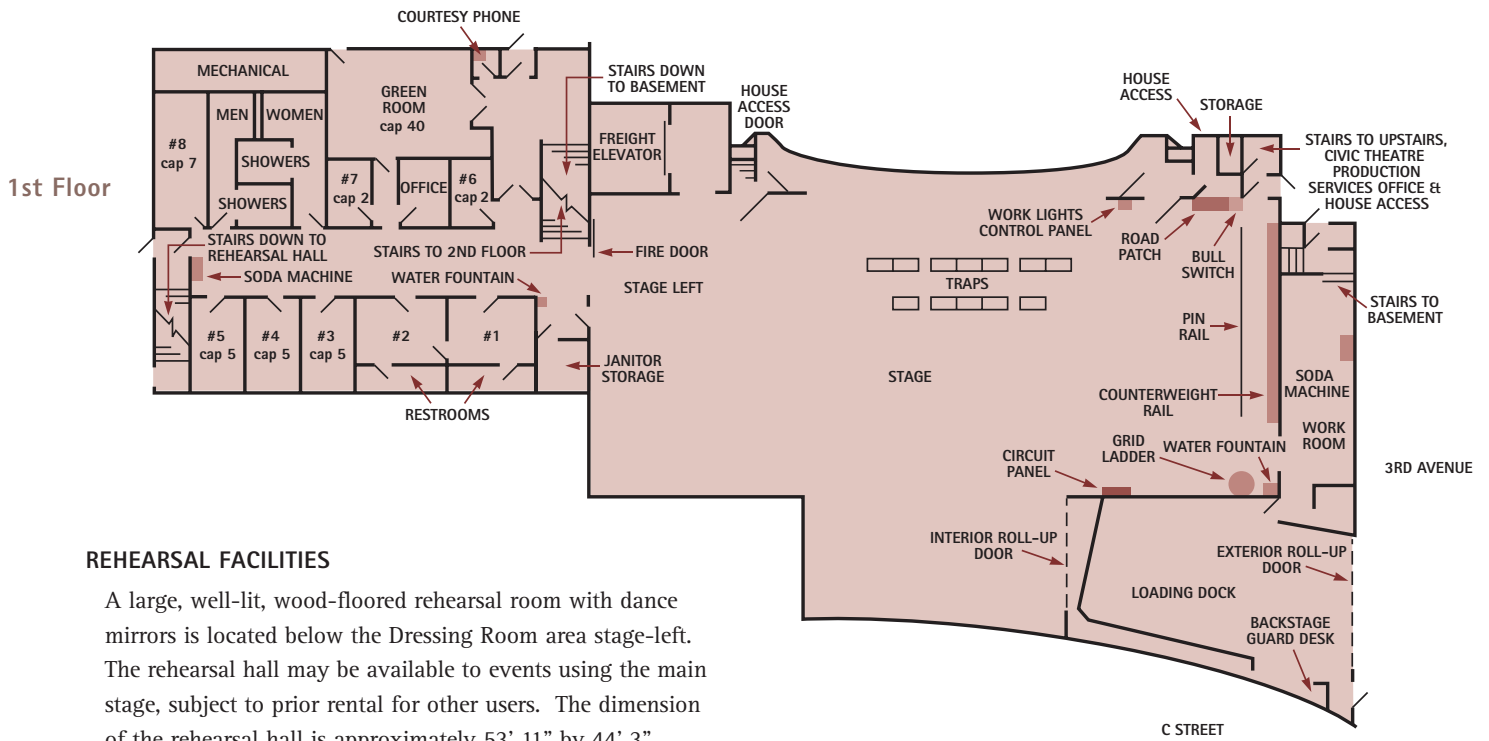

REHEARSAL FACILITIES

A large, well-lit, wood-floored rehearsal room with dance mirrors is located below the Dressing Room area stage-left. The rehearsal hall may be available to events using the main stage, subject to prior rental for other users. The dimension of the rehearsal hall is approximately 53' 11" by 44' 3".

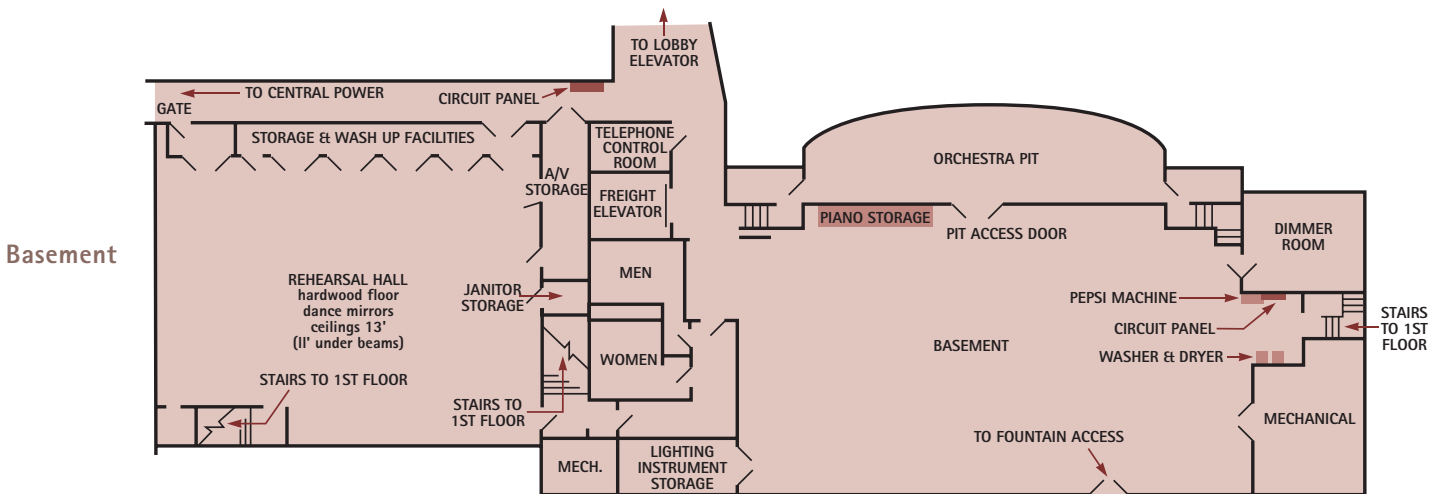

CIVIC THEATRE SEATING CONFIGURATION

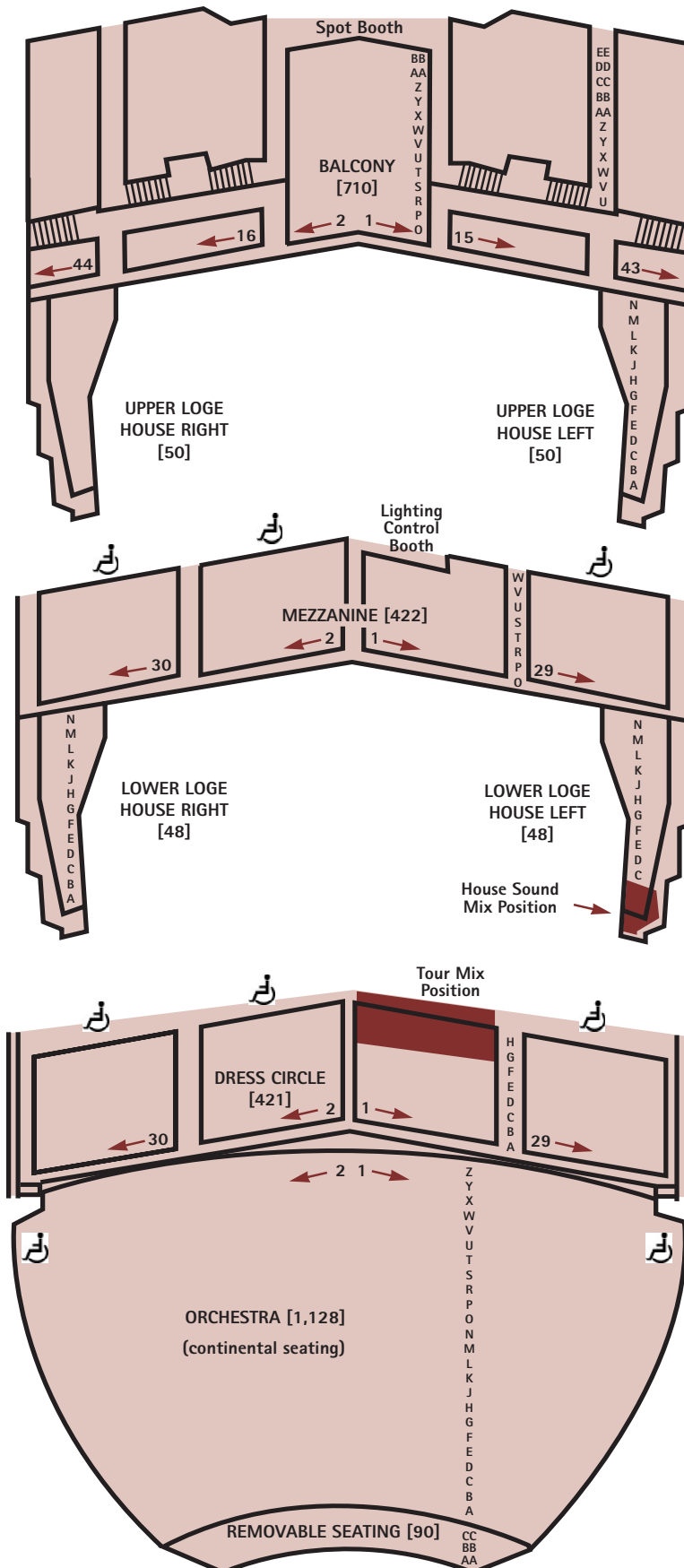

TOTAL SEATING CAPACITY	2,967
UPPER LEVEL	
Balcony	710
Upper Loges	100
MIDDLE LEVEL	
Mezzanine (incl. 12 wheelchair locations) . .	422
Lower Loges	96
DRESS CIRCLE	
Fixed (incl. 12 wheelchair locations)	394
Mixer Seats	27
Total Dress Circle	421
ORCHESTRA	
Fixed (incl. 12 wheelchair locations)	1,128
Removable Seating	
Row CC	35
Row BB	30
Row AA	25
Total Orchestra Level	1,218
Total Civic Theatre Capacity	2,967
ORCHESTRA PIT IN USE	
Standard Pit—remove	
AA & BB Revised Capacity	2,912
Extended Pit—remove	
CC also Revised Capacity	2,887

TICKETING SERVICES

San Diego Theatres operates a full-time, professional ticket sales office. Advance sales are sold at our Ticket Office located across the central plaza, adjacent to the Civic Theatre. Performance sales and will call are accommodated in our Ticket Office in the Civic Theatre lobby. Civic Theatre Ticketing uses the Ticketmaster system offering internet, telephone and outlets sales opportunities. Additionally, San Diego Theatres operates its own in-house telephone sales operation.

American Express, VISA, MasterCard and Discover credit cards are accepted for all ticket sales.

There is a \$2.50 per ticket Facility Restoration Fee assessed on all paid tickets.

Theatre Ticket Office

Hours 10 am to 6 pm, Monday thru Friday
Physical Location Third Avenue and "B" Street
Mail Orders* Theatre Ticket Office
1100 Third Avenue
San Diego, CA 92101
Theatre Ticket Office (619) 570-1100
Phone Orders* TDD for speech/hearing impaired
(619)615-4177
TicketMaster* (619) 220-TIXS
Internet Sales www.sdcivic.org
www.ticketmaster.com

**customer-paid handling/convenience charges apply*

Civic Theatre Event Ticket Office

Hours 2 hours prior to curtain for (for Day-of-Show, performances. On multiple On-Site sales only) performance days, the Civic Theatre Ticket Office remains open thru all performances until 1/2 hour after curtain of the final performance.

EVENT SETTLEMENT

A preliminary event settlement will be prepared during the final performance and is generally available for review one hour after the Ticket Office windows close.

Settlement is coordinated by your Event Manager. Please discuss all details of the settlement with your Event Manager as soon as possible to ensure accurate and timely reporting and information.

Unless otherwise arranged in advance, all settlement payments will be made by wire transfer or by check on the next business day following the event.

If any portion of the settlement is to be made in cash, the Event Manager **MUST** be notified a minimum of 10 working days in advance in order to arrange for the appropriate fund transfers.

ADVERTISING

All advertising should contain complete and accurate information concerning the event, date, time, location, ticket-pricing and sales locations, etc. Advertising should state:

*Tickets available at Civic Theatre
(619/858) 570-1100 and www.sdcivic.org*

Advertising should note that Convenience Charges may apply for outlet, phone and internet sales.

Our Ticketing Services Department can provide the most appropriate wording for your advertisements.

NOTES



1100 Third Avenue
San Diego California 92101
619.615.4000 619.615.4001 FAX
www.sandiegotheatres.org